

Components of K0310 Sliding Kits

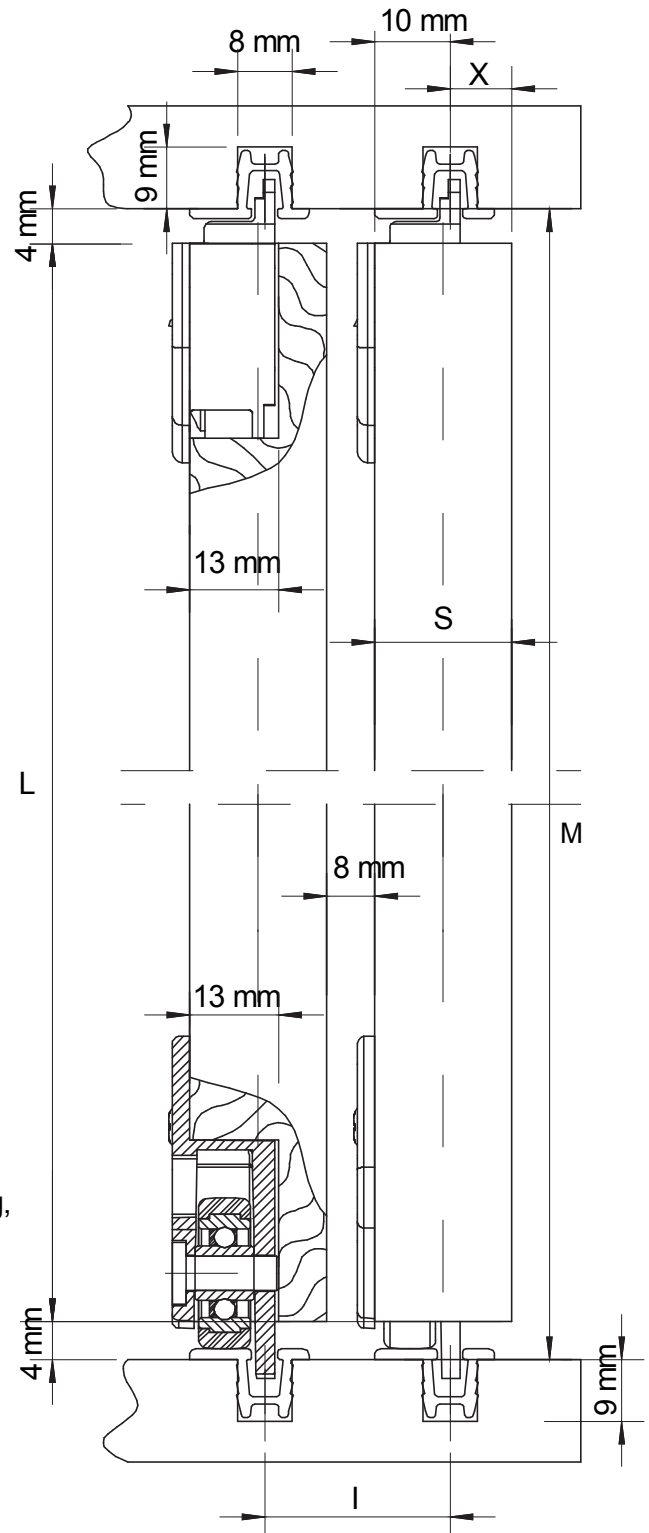
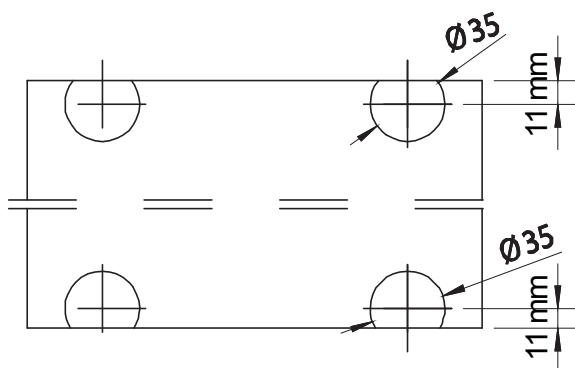

Track is sold in 3m lengths. Preparation of the door opening, track boards and track fitting should be done by a suitably qualified tradesman.

S = Door thickness

X (face of door to track centre) = S - 10mm (min 9mm)

I = S + 8mm + (Handle height - 4mm if fitted)

L (door height) = M (overall opening height) - 8mm

Note: M must be the minimum height, if the height varies across the opening.

Door width = width of opening / no. of doors, plus overlap allowance. Usual overlap allowance is 50mm per pair of overlapping doors.

Note: The door opening must be true, square and level. Variation in the height of the opening from one side to the other to be no more than 2mm. Fall in the level of the bottom track to be no more than 1mm per metre.

The Installation must be able to support the rolling weight of the doors. K0310 kits are available in two versions to suit individual door weights to 23kg and to 43kg. The two kits are identical, except the 43kg kit has heavy duty ball bearing rollers.